

Conference Venue ~ Nara

- Nara is the most historic city and was registered in World Heritage in 1998
- 60-minute transportation form Kansai international airport by train
- Close to the second largest city Osaka and the historic city Kyoto

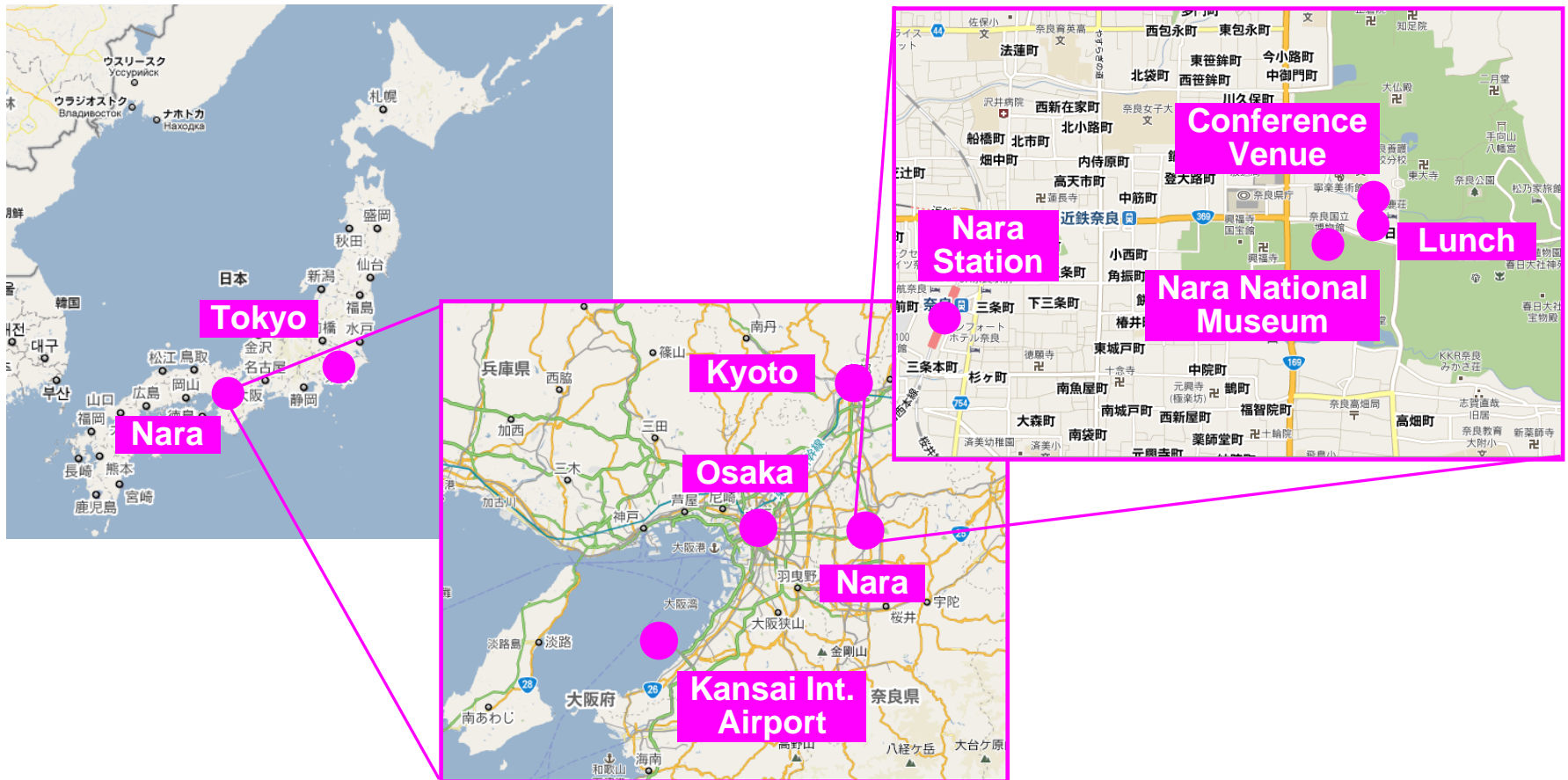

Access to Nara

- 60 min from Kansai international airport to Nara by train
- The Airport, the largest in the Kansai region, is located on a manmade island in the middle of Osaka Bay
- More than 500 weekly flights to 67 cities: 499 to Asia, 66 to Europe, 35 to North America

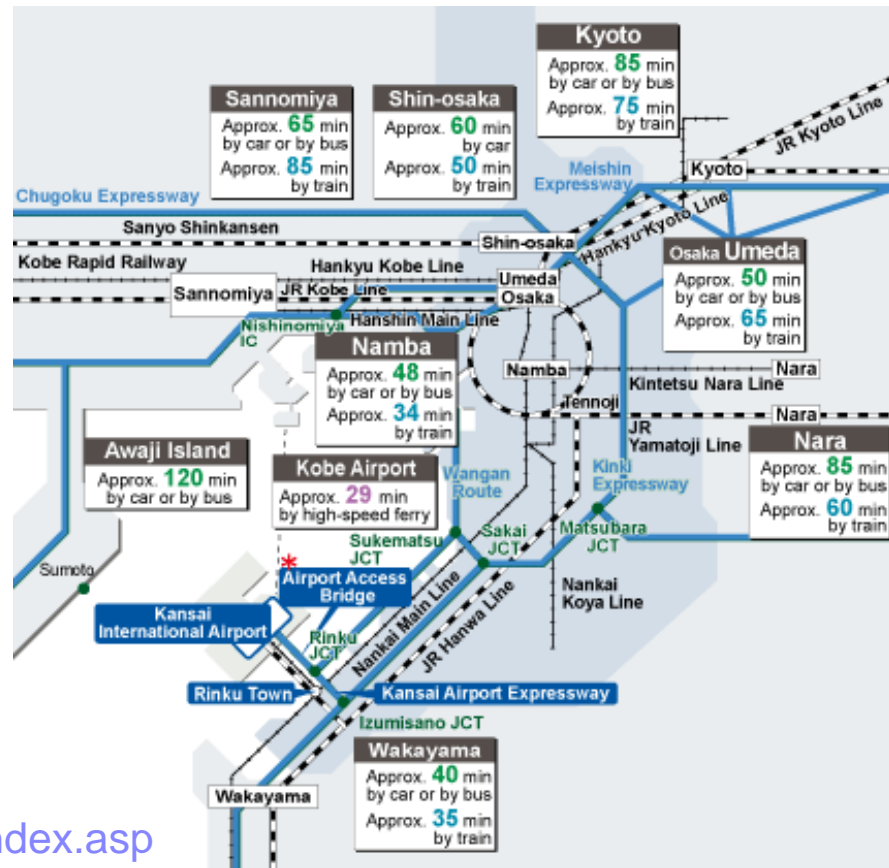

<http://www.kansai-airport.or.jp/en/index.asp>

Conference Venue ~ Nara

- The conference hall is located at the center of the World Heritage site "Historic Monuments of Ancient Nara."

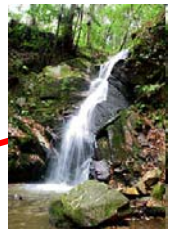

Conference Hall



Welcome Party

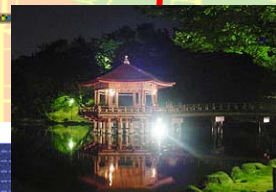

Conf. Hall & Welcome Reception (28th 17:00~)

Todai-ji Cultural Center



- Just opened Oct. 2010

- Main Hall 321 seats + 30 extra seats



http://www.obayashi.co.jp/works/work_1402

Nara National Museum



- Welcome Reception will be held at a restaurant in Nara national museum



<http://www.narahaku.go.jp/>

Conference Hall ~ Floor Plan

1st Basement

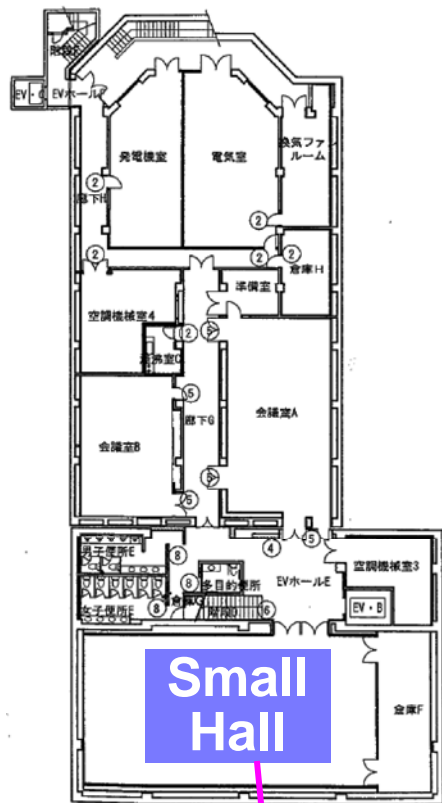

Small Hall

**Coffee Break
Exhibition**

1st Floor

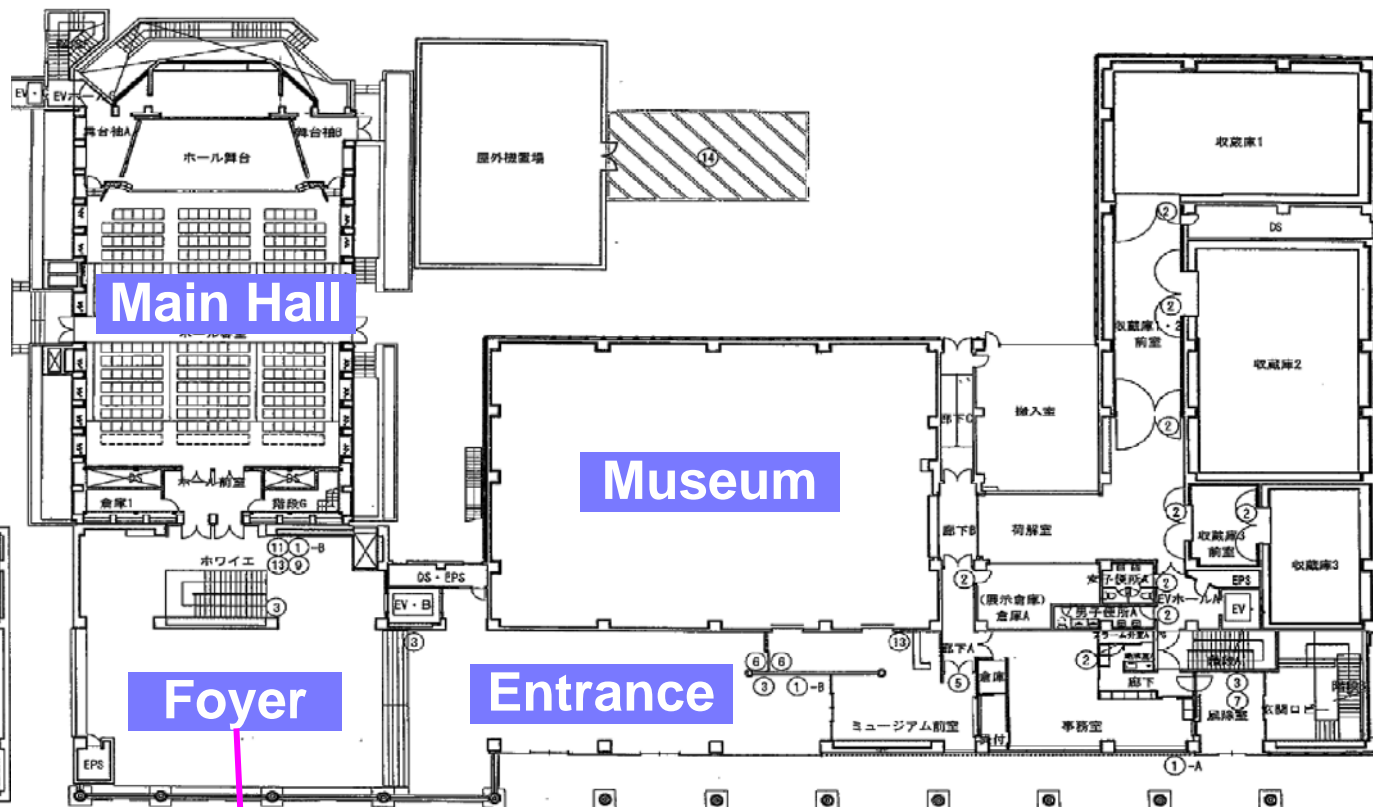

Main Hall

Museum

Foyer

Entrance

**Poster
Session**

Lunch ~ Yumekaze Hiroba

- All restaurants and shops nearby the conference hall are reserved by CHES



夢風平



天平庵



おぼろ



東大寺
門前市場



黒川本家



J
L-TOWER



絵図屋



おぼろ



大徳寺門前市場



奈良や



おぼろ



おぼろ



おぼろ



夢風ホール

<http://www.yume-kaze.com/>

Excursion (29th 16:45 – 21:30)

- Approx. 30 min. from Nara to Kaiyukan Aquarium
- Kaiyukan Aquarium is one of the largest aquariums in the world.
- Naniwa Kuishinbo Yokocho is the theme park of Osaka Cuisine. It imitates Osaka gastronomy alley in 60's.



<http://www.kaiyukan.com/language/eng/> <http://www.kaiyukan.com/thv/marketplace/kuishinbo/>

Banquet & Rump Session (30th Friday 18:30-21:30)

- Hotel Nikko Nara – 20 min walk from the conference hall



<http://www.jalhotels.com/domestic/kansai/nara/index.html>